

NOTE:
 WAYLEAVES OMITTED FOR CLARITY. REFER TO DRAINAGE & WATERMAIN LAYOUT DRAWINGS NO. 202252-PUNCH-XX-XX-DR-C-0100 & 0200

NOTES:
 1. ALL LINEMARKINGS AND SIGNAGE SHALL BE IN ACCORDANCE WITH RELEVANT CHAPTERS OF THE CURRENT EDITION OF THE TRAFFIC SIGNS MANUAL

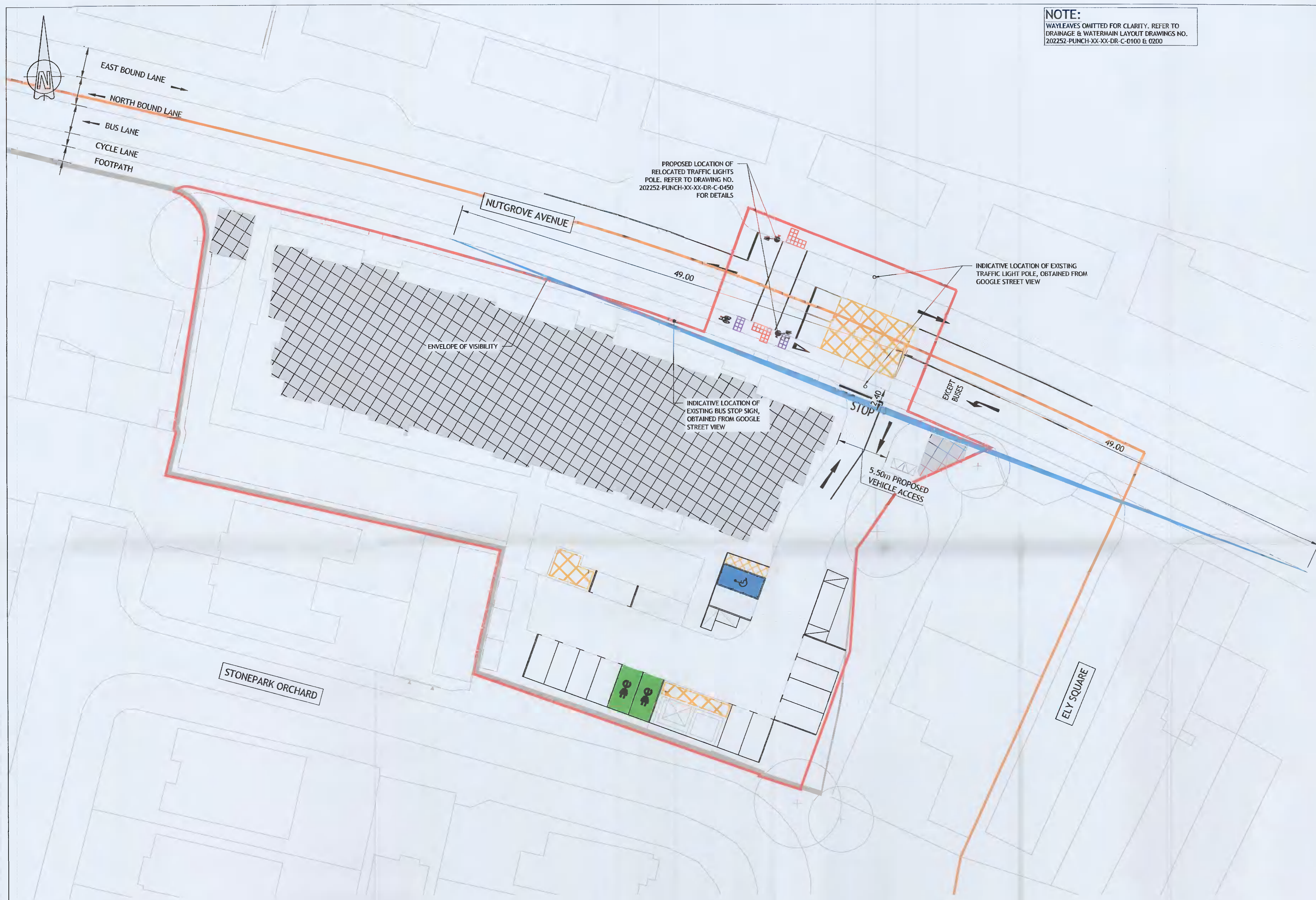

Ordnance Survey Ireland Licence No. EN 0003720
 © Ordnance Survey Ireland/Government of Ireland

© PUNCH Consulting Engineers
 This drawing and any design hereon is the copyright of the Consultants and must not be reproduced without their written consent.
 All drawings remain the property of the Consultants.
 Figures of dimension only to be taken from this drawing.
 Consultants to be informed immediately of any discrepancies before work proceeds.



Rev	Amendment	By	Date	Rev	Amendment	By	Date	Client:
C01	PLANNING ISSUE	IBS	2021/04/19					SIRIO HOMES

LEGEND:

EXTENT OF DEVELOPMENT	
INDICATIVE BOUNDARY BETWEEN DUN LAOGHAIRE RATHDOWN AND SOUTH DUBLIN COUNTY COUNCILS	

PUNCH consulting engineers
 Dublin | Limerick | Cork | Galway | Glasgow
 Carnegie House Library Road,
 Dun Laoghaire, Co. Dublin, A96 C7W7
 t: +353 1 271 2200 | w: punchconsulting.com

Project: RESIDENTIAL DEVELOPMENT, NUTGROVE AVENUE, RATHFARNHAM, DUBLIN					
Title: VISIBILITY SPLAY - SET BACK FROM EDGE OF CYCLE LANE					
Drawn: IBS	Date drawn: JANUARY 2021	Technician Check: IBS	Engineer Check: MR	Approved: PC	
Project: 202252	Drawn by: 202252-PUNCH-XX-XX-M2-C-0625	Checked by: AD	Drawn Status: AD PLANNING	Revision No: C01	
Scale: 1:200	Document No: 202252-PUNCH-XX-XX-DR-C-0626				