

ATTIC CONVERSION TO HAVE SELF CLOSING FIRE DOOR, NEW ACCESS STAIRS WITH FIRE RATING WALLS AND ESCAPE WINDOWS IN DORMER WINDOW PROJECTION / ALL INTERNAL WALLS TO BE FIRE SLABBED  
 FIRE DETECTION WITH HEAT AND SMOKE ALARM IN NEW ROOM CONNECTED TO MAINS  
 LOFT CONVERSION TO COMPLY WITH TECHNICAL GUIDANCE DOCUMENT B- FIRE SAFETY VOLUME 2 DWELLING HOUSES (2017)  
 ENCLOSURE OF EXISTING STAIRWAY, NEW STAIRWAY TO ADDITIONAL STOREY, DOORWAYS TO BE FIRE RATED DOORS WITH SELF CLOSER  
 FIRE DETECTION TO BE TIED INTO MAINS

Stairs to manufactures spec.  
 60mins fire proof door / walls / self closing door  
 new smoke alarm / heat detector

PROPOSED NEW TIMBER FRAMED DORMER TO REAR WITH IKO EASYSEAL SELF ADHESIVE FELT WITH IKO BM EASYSEAL UNDERLAY AND IKO 6M EASYSEAL CAP SHEET ON 22MM EXTERNAL GRADE PLYWOOD ON TREATED TIMBER FIRTINGS LAID TO FALLS. ALLOW FOR 50MM AIR GAP IN DEPTH PF FIRTINGS FROM UNDERSIDE OF DECK TO TOP OF INSULATION IKOPRO SA BITUMEN PRIMER TO PER APPLIED TO MANUFACTURES RECOMMENDATIONS

CONTRACTOR TO PROVIDE FOR MIN 100MM KINGSPAN KQULTHERM K7 INSULATION BETWEEN RAFTERS ALL TO BE TAPED AND FULLY SKIMMED, CONTRACTOR TO ENSURE A CLEAR AIR SPACE FROM SOFFIT TO RIDGE BOARD AND IS MAINTAINED ABOVE THE RAFTERS FOR FULL EXTENT OF ROOF REFER TO KINGSPAN FOR INSTALLATION DETAILS ALL NEW TIMBERS TO STRUCTURAL ENGINEERS DESIGN AND DETAILS

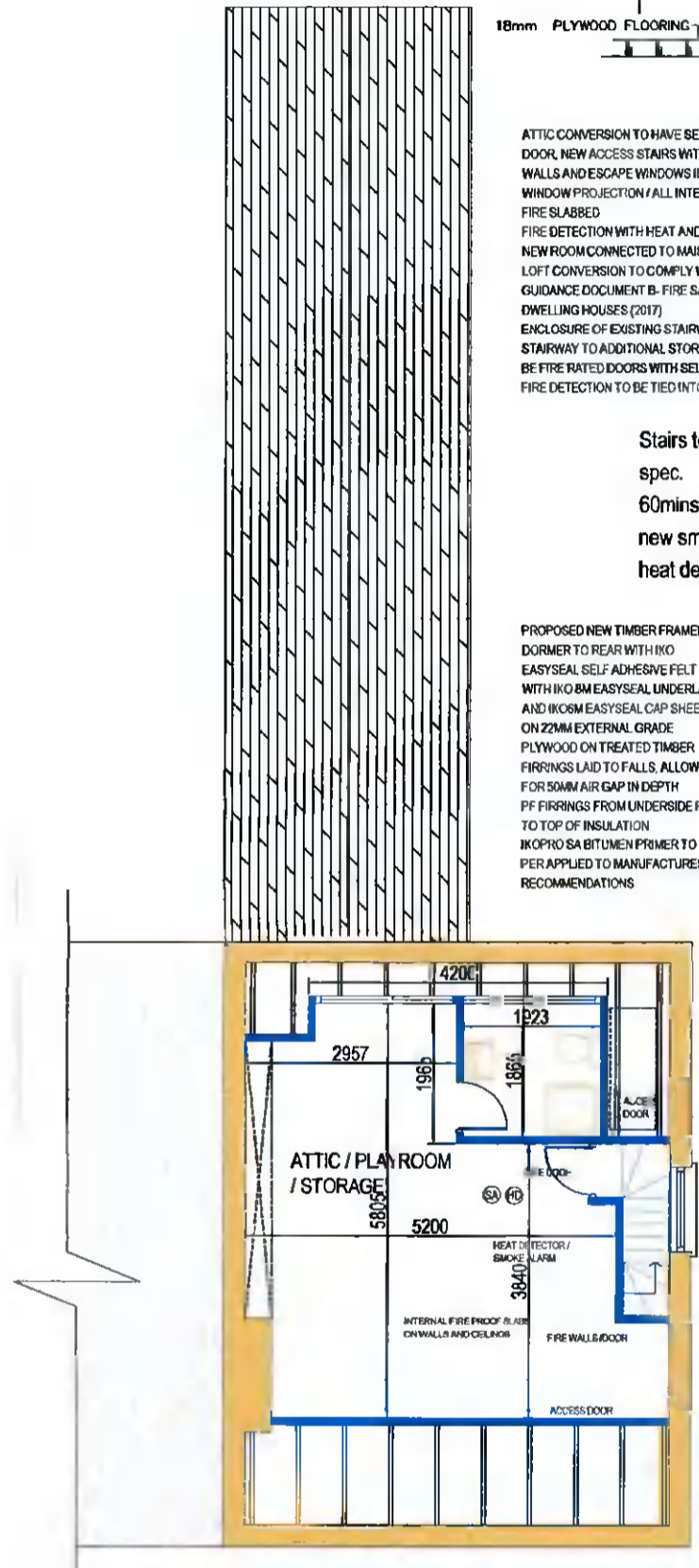

PROPOSED ATTIC FLOOR PLAN

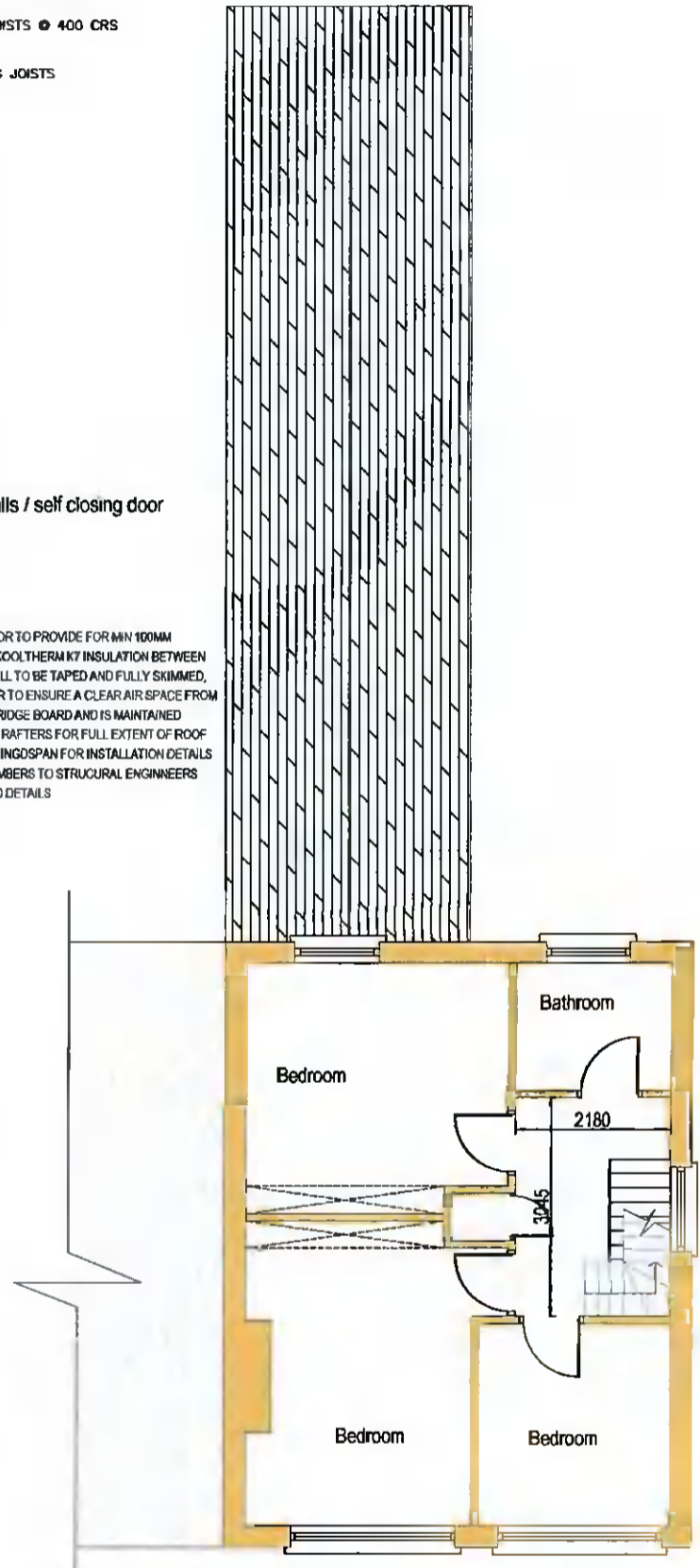

PROPOSED FIRST FLOOR PLAN



H2B 20 MOY VIEW KILDALKEY CO MEATH		tel: 01 4030922 / 087 1326871	
project	PROPOSED ATTIC CONVERSION - JOHN SWIFT 12 Dunmore lawn Kingswood Tallaght Dublin 24	project number <b>2018-17</b>	date 17/03/2021
subject	PROPOSED PLANS	drawing number <b>2018-16A</b>	scale 1:100
		designed by JACKIE QUINN	size <b>A3</b>
		checked by BRENDAN JOHNSTON	

PLANNING DRAWINGS ONLY