

# Planning Pack Map

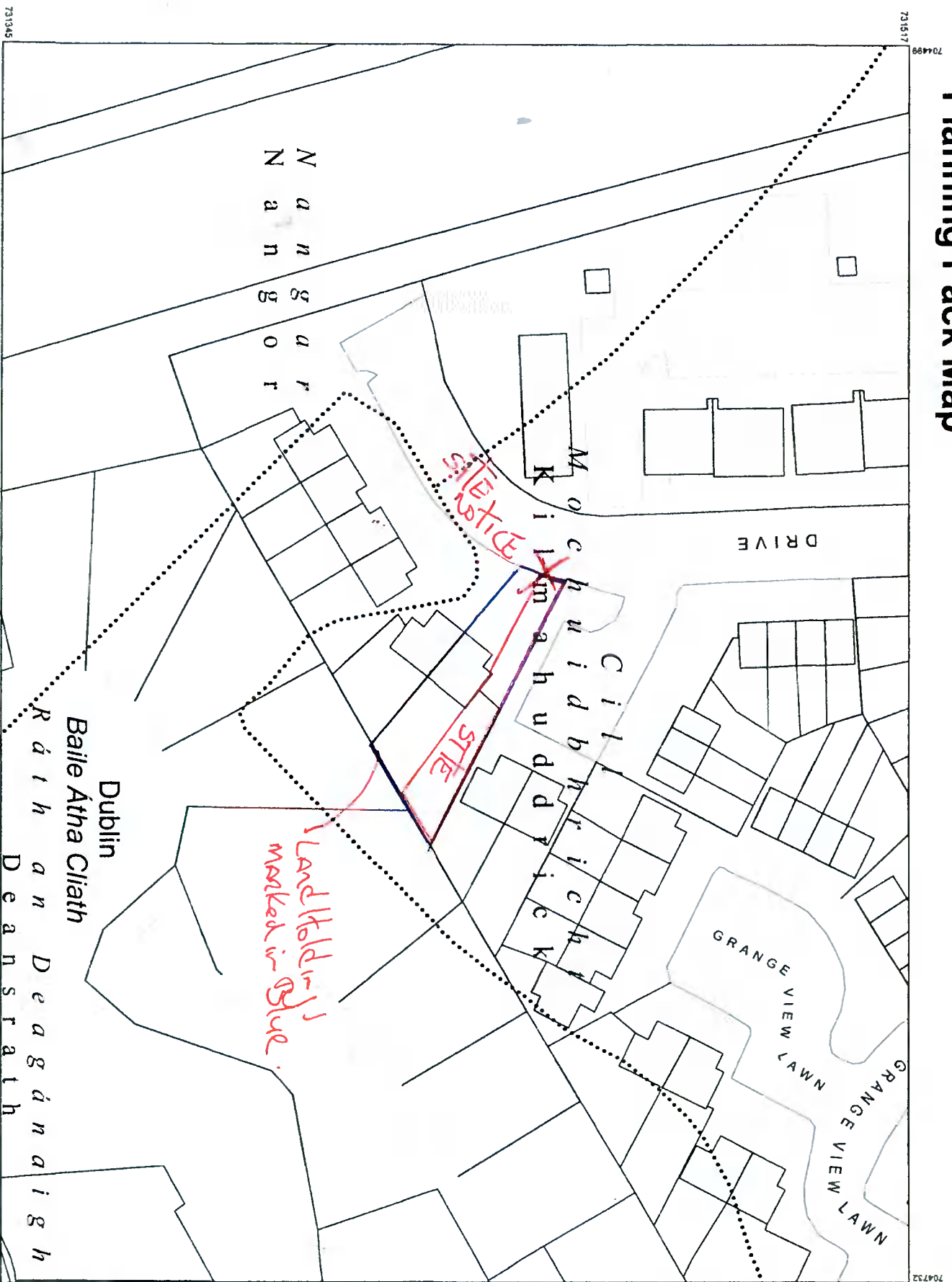

**CENTRE COORDINATES:**  
ITM 704616/731431

**PUBLISHED:** 03/04/2021  
**ORDER NO.:** 50182661\_1

**MAP SERIES:** 1:1,000  
1:1,000  
1:2,500

**MAP SHEETS:** 3326-02  
3326-07  
3326-A

*H2B Architects*  
*Maryam Khatami*  
*Man & Ned*

**COMPILED AND PUBLISHED BY:**  
Ordnance Survey Ireland,  
Phoenix Park,  
Dublin 8,  
Ireland.

Unauthorised reproduction infringes Ordnance Survey Ireland and Government of Ireland copyright.

All rights reserved.  
No part of this publication may be copied, reproduced or transmitted in any form or by any means without the prior written permission of the copyright owners.

The representation on this map of a road, track or footpath is not evidence of the existence of a right of way.

Ordnance Survey maps never show legal property boundaries, nor do they show ownership of physical features.

© Suirbhéireacht Ordánais Éireann, 2021  
© Ordnance Survey Ireland, 2021  
[www.osi.ie/copyright](http://www.osi.ie/copyright)

**LEGEND:**  
<http://www.osi.ie>  
search 'Large Scale Legend'

**CAPTURE RESOLUTION:**  
The map objects are only accurate to the resolution at which they were captured. Output scale is not indicative of data capture scale. Further information is available at: <http://www.osi.ie>; search 'Capture Resolution'

**OUTPUT SCALE:** 1:1,000



# Site Location Map

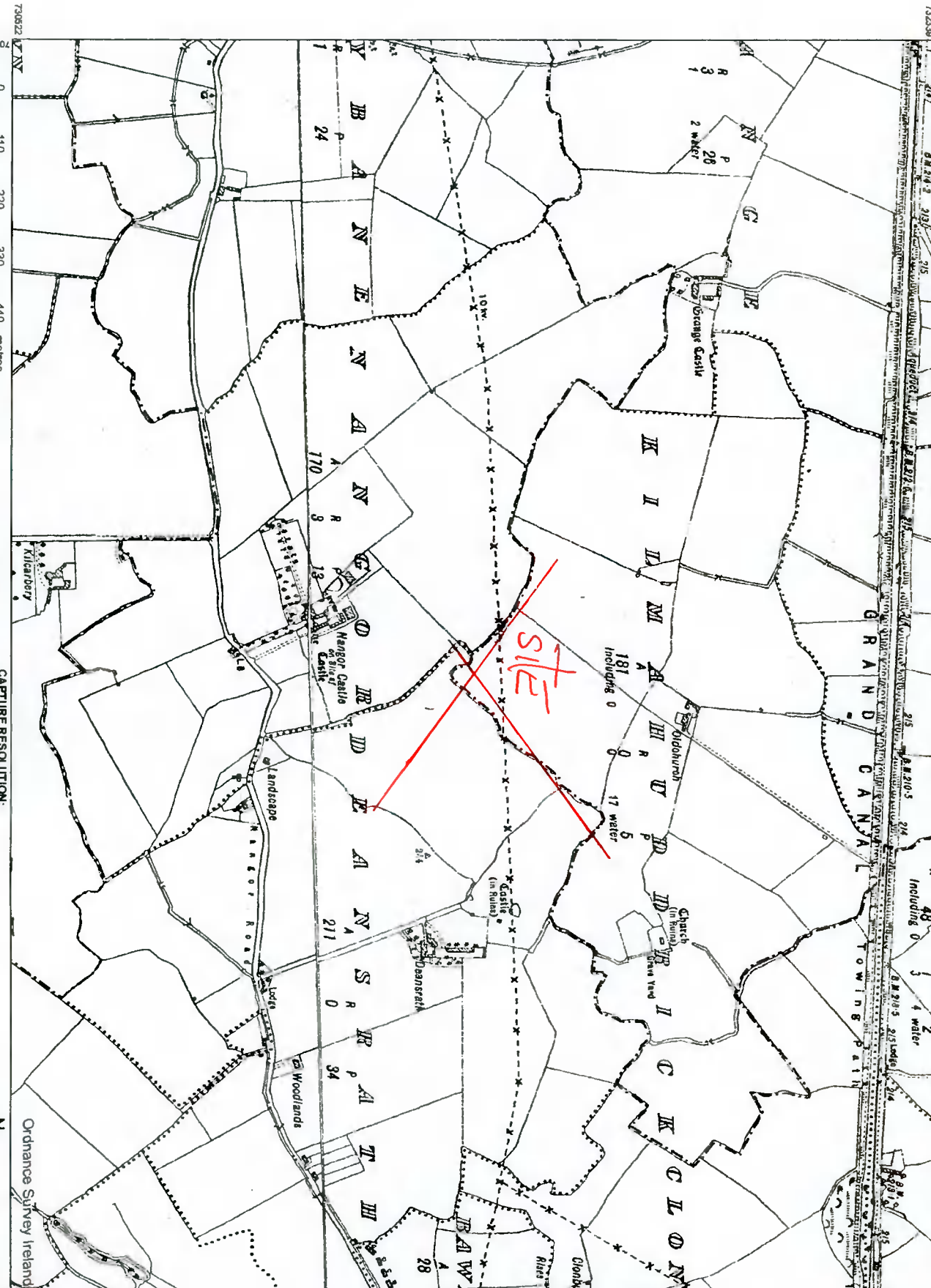

**CENTRE COORDINATES:**  
ITM 704616, 731431

**PUBLISHED:** 03/04/2021  
**ORDER NO.:** 50182661\_1

**MAP SERIES:** 6 Inch Raster DN017, 6 Inch Raster DN021, 6 Inch Raster KE011, 6 Inch Raster KE015  
**MAP SHEETS:** DN017, DN021, KE011, KE015

**COMPILED AND PUBLISHED BY:** Ordnance Survey Ireland, Phoenix Park, Dublin 8, Ireland.

Unauthorised reproduction infringes Ordnance Survey Ireland and Government of Ireland copyright.

All rights reserved. No part of this publication may be copied, reproduced or transmitted in any form or by any means without the prior written permission of the copyright owners.

The representation on this map of a road, track or footpath is not evidence of the existence of a right of way.

Ordnance Survey maps never show legal property boundaries, nor do they show ownership of physical features.

© Suirbhreacht Ordánais Éireann 2021  
© Ordnance Survey Ireland, 2021  
www.osi.ie/copyright

**LEGEND:**  
<http://www.osi.ie>  
search 'Large Scale Legend'

**CAPTURE RESOLUTION:**  
The map objects are only accurate to the resolution at which they were captured. Output scale is not indicative of data capture scale. Further information is available at: [http://www.osi.ie/search/Capture Resolution](http://www.osi.ie/search/Capture%20Resolution)

**OUTPUT SCALE: 1:10,560**

